

# Hot Foil Stamping STM 500 IA

## Application

Hot foil stamping and heat transfer machine designed for decorating flat top surfaces of caps and closures.

## Features

- Rigid frame construction
- Pick & place system with linear slides for part loading & unloading
- Indexer with 5 stations
- Adjustable pneumatic stroke for achieving higher speeds
- 4-axis adjustable stamping head
- Touch screen operator interface
- Multiple sensors such as foil break sensor, non-ejection sensor
- Detailed PLC component diagnostics

## Optionals

- Auto part feeding
- Bowl feeder with optional noise reducing enclosure
- 3 side safety enclosure
- Can be integrated with upline/downline machines
- Remote Diagnostics
- Password and user log facility
- Language options for different countries
- Double foil feed for dual colour hot foil stamping



# Hot Foil Stamping STM 500 IA

## Technical Specifications

- Machine Speed : Up to 30-32 parts / minute
- Flat Stamping : Dia - ø90mm (max)
- Stamping Plate : 115 mm (length) x 100mm (depth)
- Heater : Cartridge heaters - 400 watt
- Air Supply : 7-10 Bar
- Air Consumption (at 6bar) : 0.15m<sup>3</sup>min
- Electrical Supply : L, N, PE
- Supply Voltage : 230 VAC, 50/60 Hz
- Supply Current : 5 Amps
- Load : 1.5kW
- Machine Weight without bowl feeder : approx. 900 kg.
- Machine Weight with bowl feeder : approx. 1000 kg.

## Application Example



Layout :

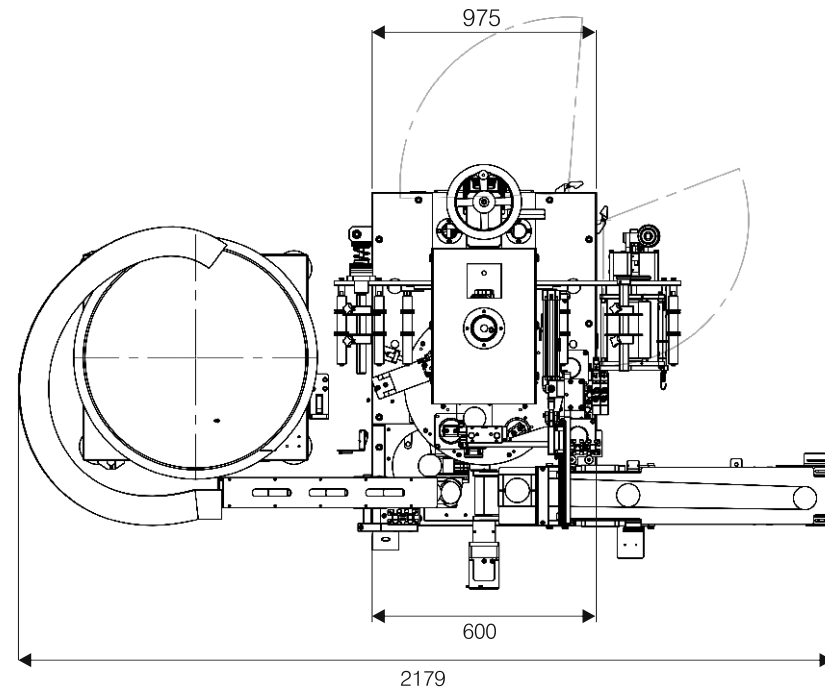
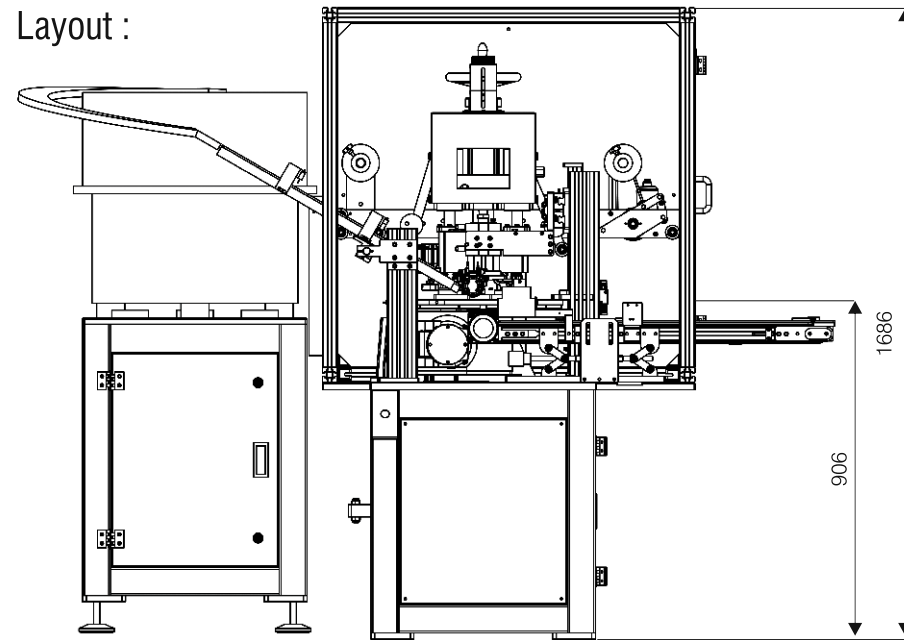

 **Technoshell**  
Automations Pvt. Ltd.

G - 49, M.I.D.C., Ambad, Nashik - 422010. INDIA

Ph.: +91 253 6647 300.

Email: [info@technoshell.com](mailto:info@technoshell.com) | URL: [www.technoshell.com](http://www.technoshell.com)

For Machine Video

