

Salient Features



- » Ideally suited for Medium scale production
 - » Fully cGMP compliant Tablet Press in terms of Design, Metallurgy, Easy Accessibility etc.
 - » Turret with Electroless Nickel Plating for excellent corrosion resistance.
 - » Direct drive to the Turret thru' high torque reduction gear box.
 - » Large capacity motor ensures no jerks/slippages even when compressing large tablets.
 - » Pre & Main Compression rollers tonnage capacity:
D tooling: 20 kN (2 Ton) & 100 kN (10 Ton)
B & BB tooling: 20kN (2 Ton) & 60 kN (6 Ton)
 - » Segmented type double walled Cams design for easy maintenance & change over.
 - » Double Paddle Force Feeder with Clockwise & Counter Clockwise rotation of paddles.
-
- » Main & Feeder Motor control through AC Variable Frequency Drive.
 - » Force feeder can be run at very low speed (5 RPM), which makes it ideal for handling critical formulation like MUPS®
 - » The Automatic Startup / Stop Tablet Rejection for segregation of tablets produced during initial & final stage of the batch.
 - » Swing Arm mounted Control Panel includes:
 - SMART Touch Screen HMI
 - Mode Selector Switch for SETUP / OFF / RUN
 - START / STOP Switches, Emergency Stop
 - » Compression & Ejection Force Measurement with Load Cell & NI system (Optional)
 - » 'TOOL SAFE' overload system (Optional)
 - » Bi-Layer attachment with Online Auto Sampling of 1st layer thru' touch screen (Optional)



Force Feeder



Turret Drive Gear Box



Lower Compression Zone & Bottom Drive to Turret

TECHNICAL SPECIFICATIONS

Model		EP - 400		
Tablet Press Type		Double Rotary		
Number of Stations	29	37	45	
Tooling	EU-D	EU-B	EU BB	
Tablet Output (Tab/hr) (Max.)*	174,000	222,000	270,000	
Turret Speed	10 - 50 RPM			
Tablet Diameter (Max.)	25 mm	16 mm	13 mm	
Filling Cam Depth	12 / 16 / 20 mm	8 / 12 / 17 mm	8 / 12 / 17 mm	
Main Pressure (Max.)	100 kN (10 Ton)	60 kN (6 Ton)		
Tablet Thickness (Max.)	8 mm			
Variable Upper Punch Insert	2.0 / 3.5 / 4.75 / 6.0 / 8.0 mm			
Pre Pressure (Max.)	20 kN (2 Ton)			
Feeder	Double Paddle Force Feeder (Standard) Gravity Feeder (Optional)			
Machine Footprint – Main Machine	1175 x 1105 mm			
Machine Height (without Hopper)	1800 mm			
Machine Height (with Hopper)	1900 mm			

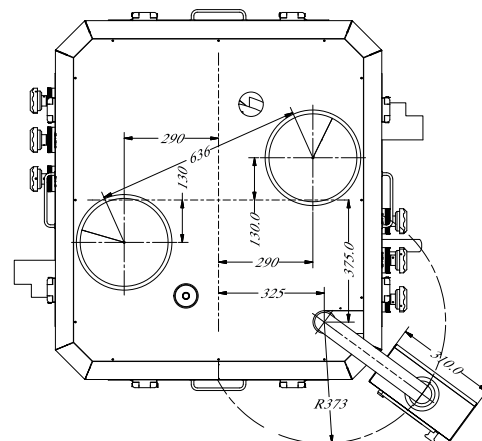

TOP VIEW

* Machine output mentioned are rated outputs and can vary depending on the product characteristics, Tablet dimensions / shape / size, depth of fill, ambient conditions, operator skill and machine maintenance.



Compression Zone

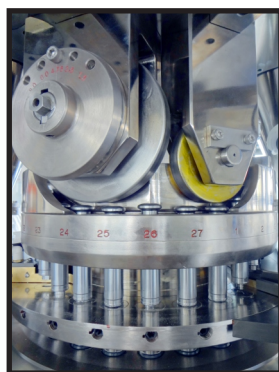

Pre Compression & Main Compression



Touch Type MMI

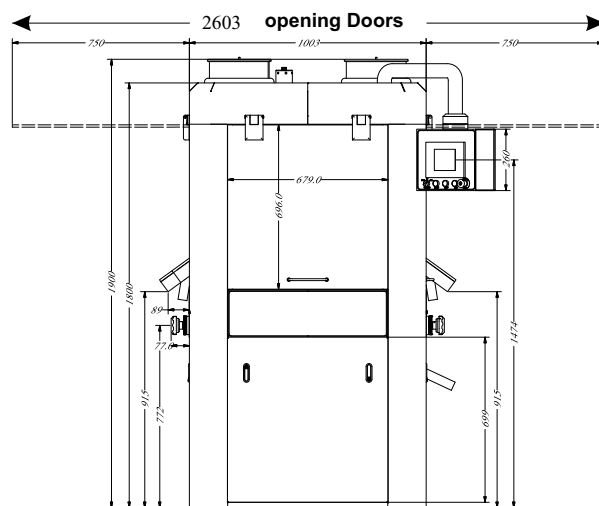

FRONT VIEW



SERVICE SUPPORT

- ▶ Ahmedabad
- ▶ Chennai
- ▶ Hyderabad
- ▶ Bengaluru
- ▶ Delhi
- ▶ Indore
- ▶ Chandigarh
- ▶ Goa
- ▶ Sikkim



Parle Elizabeth Tools Pvt. Ltd.

329/P, Behind J.K Weigh Bridge, Opp. Harsha Engineering,
Changodar, Ahmedabad, - 382213 Tel: +91 7600017570
info@parle-elizabeth.com www.parle-elizabeth.com

BRANCH OFFICE

- ▶ Ahmedabad
- ▶ Delhi
- ▶ Pinjore
- ▶ Bengaluru
- ▶ Goa
- ▶ Chennai
- ▶ Hyderabad