

## Salient Features

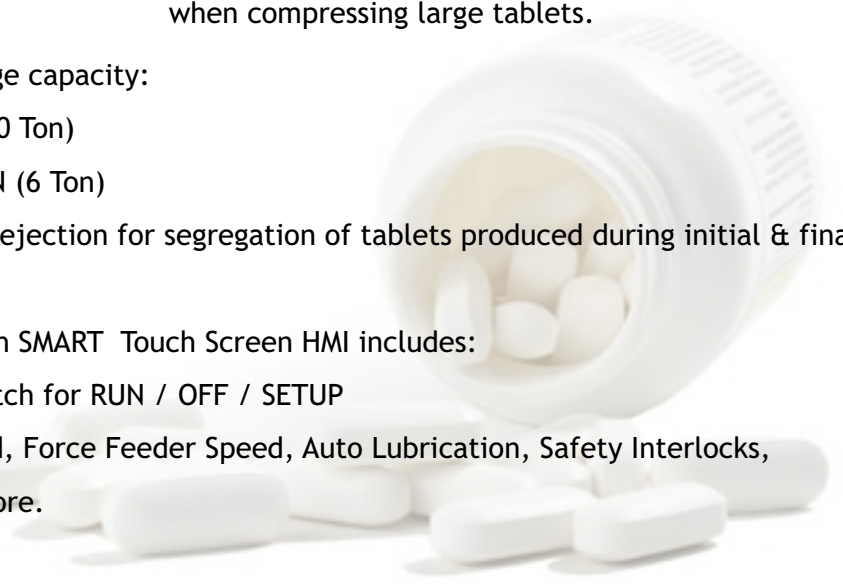

- » Ideally suited for Large volume production
- » Fully cGMP compliant Tablet Press in robust four pillar construction.
- » Precision machined Electroless Nickel Plated Turret with double thrust bearing & lower punch seal.
- » Sliding Press Roll Assembly for easy changeover
- » AHCOS - Auto Hydraulic Compression Overload System.
- » Internal Helical Drive to the Turret through high torque reduction gear box.
- » Three stage Paddle Force Feeder with Clockwise & Counter Clockwise rotation of paddles.
- » Main & Feeder Motor control through AC Variable Frequency Drive.
- » Large capacity motor ensures no jerks/slippages even when compressing large tablets.

- » Pre & Main Compression rollers tonnage capacity:
  - D tooling: 20 kN (2 Ton) & 100 kN (10 Ton)
  - B & BB tooling: 20kN (2 Ton) & 60 kN (6 Ton)
- » The Automatic Startup / Stop Tablet Rejection for segregation of tablets produced during initial & final stage of the batch.
- » Swing Arm mounted Control Panel with SMART Touch Screen HMI includes:
  - Emergency Stop, Mode Selector Switch for RUN / OFF / SETUP
  - Parameters setting like Turret Speed, Force Feeder Speed, Auto Lubrication, Safety Interlocks, Hydraulic Compression and many more.
  - Storage & recall of 100 Recipes.
- » Bi-Layer attachment with Online Auto Sampling of 1st layer through “touch screen” (Optional)



Hopper Assembly with Powder Control Valve

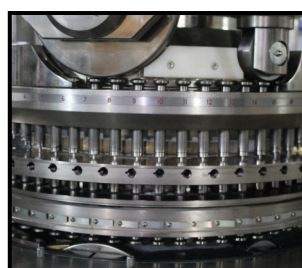

Turret Assembly



Force Feeder Zone

# TECHNICAL SPECIFICATIONS

Model	ECO - VII AFR		
Tablet Press Type	Double Rotary		
Number of Stations	51	61	75
Tooling	EU-D	EU-B	EU BB
Tablet Output (Tab/hr) (Max.)*	Single Layer - 367,200	Single Layer - 439,200	Single Layer - 540,000
	Bi Layer - 91,800	Bi Layer - 109,800	Bi Layer - 135,000
Turret Speed	10 - 60 RPM		
Tablet Diameter (Max.)	25 mm	16 mm	13 mm
Filling Cam Depth	12 / 16 / 20 mm	8 / 12 / 17 mm	8 / 12 / 17 mm
Tablet Thickness (Max.)	8 mm		
Variable Upper Punch Insert	1.5 / 3.5 / 4.75 / 6.0 / 8.0 mm		
Main Pressure (Max.)	100 kN (10 Ton)	60 kN (6 Ton)	
Pre Pressure (Max.)	20 kN (2 Ton)		
Feeder	3 Paddle Force Feeder		
Machine Footprint – Main Machine	1244 x 1244 mm		
Machine Height (without Hopper)	1847 mm		
Machine Height (with Hopper)	1877 mm		
Net Weight	4500 kg		
Gross Weight	5055 kg		

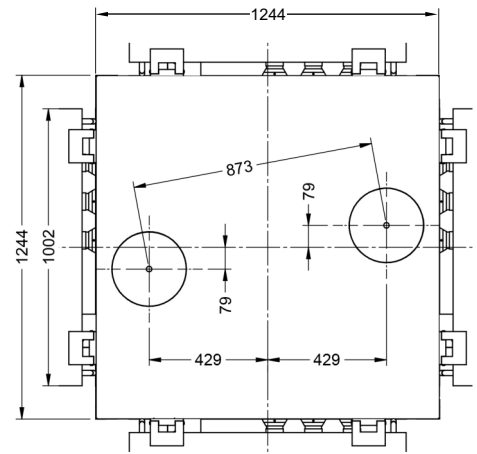

Top View

\* Machine output mentioned are rated outputs and can vary depending on the product characteristics, Tablet dimensions / shape / size, depth of fill, ambient conditions, operator skill and machine maintenance.



Eco VII with Swing arm (Standard Model)

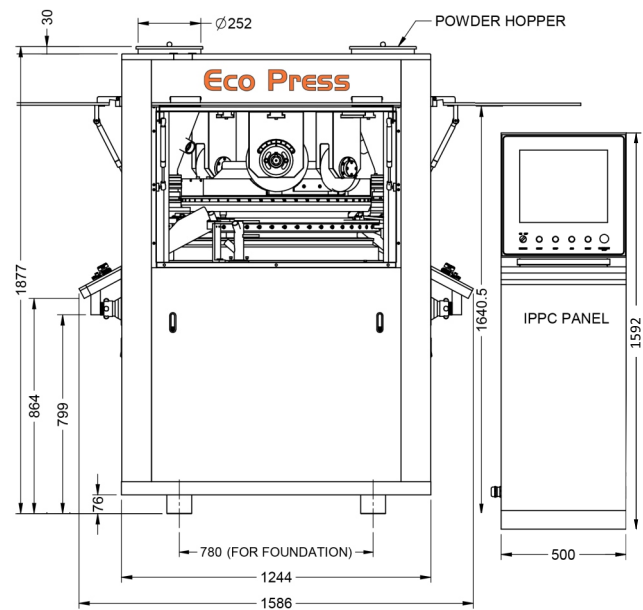

Front View



## Parle Elizabeth Tools Pvt. Ltd.

329/P, Behind J.K Weigh Bridge, Opp. Harsha Engineering, Changodar, Ahmedabad - 382213 Tel: +91 7600017570  
info@parle-elizabeth.com www.parle-elizabeth.com

### SERVICE SUPPORT

- ▶ Ahmedabad
- ▶ Chennai
- ▶ Hyderabad
- ▶ Bengaluru
- ▶ Delhi
- ▶ Indore
- ▶ Chandigarh
- ▶ Goa
- ▶ Sikkim

### BRANCH OFFICE

- ▶ Ahmedabad
- ▶ Delhi
- ▶ Pinjore
- ▶ Bengaluru
- ▶ Goa
- ▶ Chennai
- ▶ Hyderabad