

CVC1267 Plastic Bottle Unscrambler

- Lower Operating Costs

- Increase Operating Flexibility

- Unparalleled Service

- Quality that your Customers Demand



The CVC1267 Bottle Unscrambler is designed to automatically feed bottles from a bin and place them upright onto a conveyor at speeds of up to 200 bottles per minute. The CVC1267 is PLC controlled and comes standard with a 6" touch screen panel. Options include ionized air rinse with vacuum, fallen bottle sensor with return to bin, low level hopper sensor, tower lamp, and static eliminator bar.

Solid Dose Bottling Lines

• Built to cGMP Standards • Stainless Steel Construction • 10 Channels of Memory • Quick & Easy Change Over

Blister Packaging
Cartoners
Labelers

"Leading Global Equipment Supplier"

www.cvcusa.com



CVC Technologies, Inc.

CVC1267 Technical Specifications

Standard Features:

- PLC Controlled
- 6" Touch Screen Panel
- Stainless Steel Frame on locking casters
- Memory capacity for 10 jobs
- Interlocked Safety Shield
- Incremental Scales on all manual adjustments
- Low Level hopper control
- Bottle backlog sensor at outfeed
- Capacity: up to 200 bottles per minute (BPM)
- ISO 9001:2000 Certified

Container Specifications:

- Bottle Height: 2" to 8" (51mm - 203mm)
- Bottle Diameter: 1-1/4" to 4-1/4" (32mm - 108mm) or 1-3/4" to 5" (44mm - 127mm)
- Neck Opening: 1" to 3-1/4" (25mm - 83mm) or 1-1/4" to 4-1/4" (32mm - 108mm)
- Minimum Bottle height/diameter ratio: Min. 1 : 1-1/2" (25mm : 38 mm)
- Bottle height up to Shoulder: Min. 1-3/4" (44mm)

Machine Specifications:

- Hopper Capacity: 24 cu. ft.
- Machine Weight: 2,998 Lbs. (1360kg)
- Noise Level: 78 dB

Air/Electrical Requirements:

- Power Source: 220V, 50/60 Hz, Single Phase
- Power Consumption: 5 Amp
(9 Amp when equipped with Air Rinse & Vacuum)
- Air Pressure: Minimum 87 psi (ISO 8573-1)
- Air Consumption: 4 cfm (100 liters / min)
(21 cfm (800 liters / min) when equipped with air rinse)



Quality • Value • Service

Authorized CVC Dealer

Copyright © CVC Technologies, Inc. • April 2013 Edition

Available Options:

- Static eliminator bar in disc sorter
- Ionized air rinsing assembly with collection tray
- Upside down bottle, fallen bottle reject assembly
- Pre-sorter disc & discharge chute
- Siemens Controls and HMI
- Tower lamp

Machine Layouts:

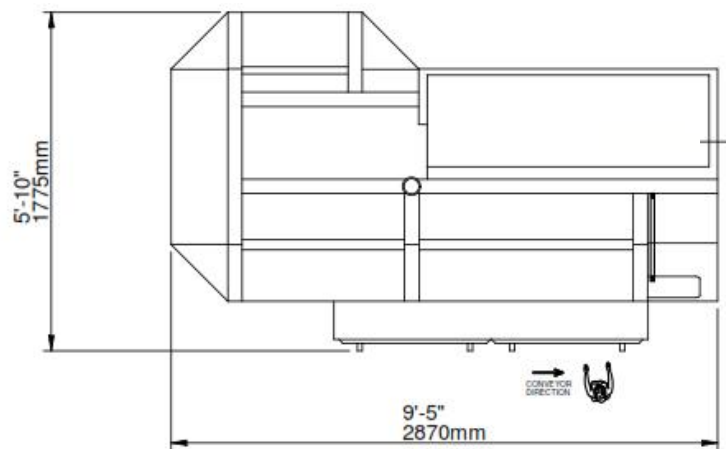

Top View

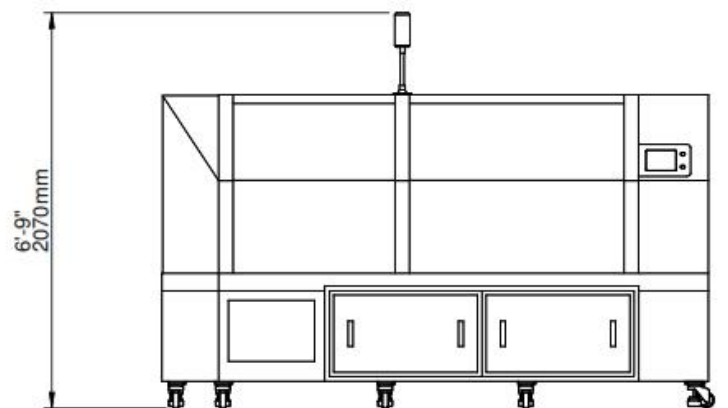

Front View

Dimensions shown are for a standard machine. This machine can run independently or can be integrated into an automated packaging line. All CVC equipment is covered by a one year parts warranty. Full Warranty details are included in our equipment proposals or can be found on our website.