

# SKF 5000

## Overflow Liquid Filler



Based on a heavy-duty stainless steel frame, our automatic level-filling machine utilizes the latest technology to consistently fill to a consistent level every time. You will find that it is another SureKap model built for maximum efficiency and versatility.

Features include:

- *Water-thin (foaming or non-foaming) to medium viscosity fluids*
- *(6) Stainless Steel nozzles (expandable to 12 nozzles)*
- *PLC controlled with keypad input*
- *50 GPM Stainless Steel centrifugal pump*
- *20 gal. Stainless Steel rear supply tank*
- *12 spout Stainless Steel manifold*
- *On casters for complete portability*
- *Fills 1 oz. to gallons*
- *Heavy duty stainless steel frame*
- *NEMA 4 Control Box*
- *Variable Speed Washdown DC Motor*
- *Air Requirements: Approx. 2 CFMs @ 100 psi*
- *Electrical Requirements: 115V/60hz/1 phase; 11 amps*

**RECOMMENDED FOR:** Water thin to medium viscosity, foamy or non-foamy products.

Options: Fully Automatic Bottle Indexing  
Drip Tray  
Hazardous Location Construction  
Conveyor

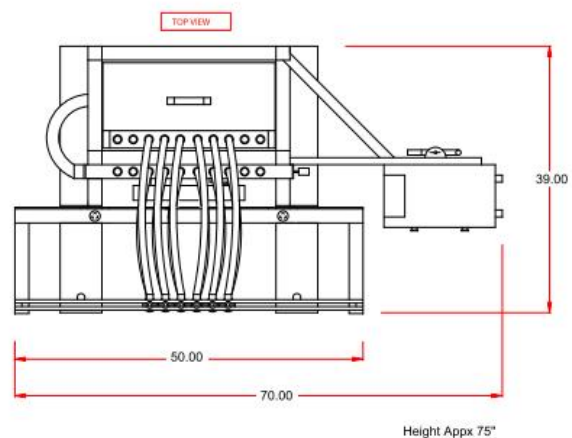
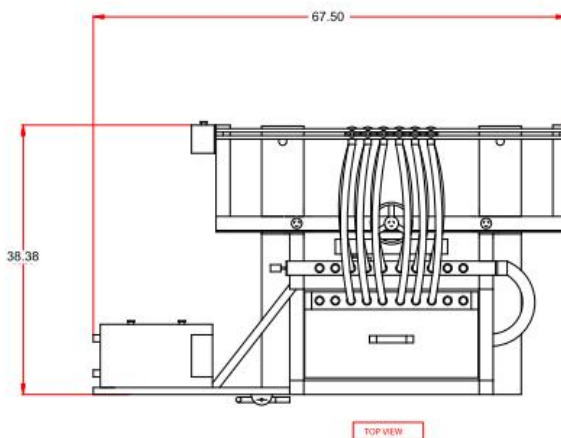

Contact:  
579 Barrow Park Drive  
Winder, GA 30680  
Sales Department: 770-307-4755  
Fax: 770-868-1348  
Email: sales@surekap.com



**SUREKAP** Inc.

Manufacturers of Quality Packaging Equipment